

4-7 mounting hole.
11 deep counterbore, depth 6.5
4-4.5 mounting hole.
7.5 deep counterbore, depth 4.5

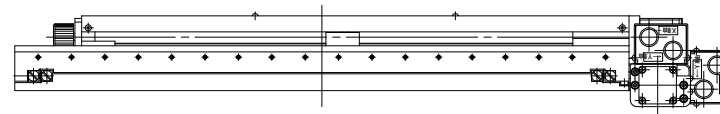

Connector position can be changed

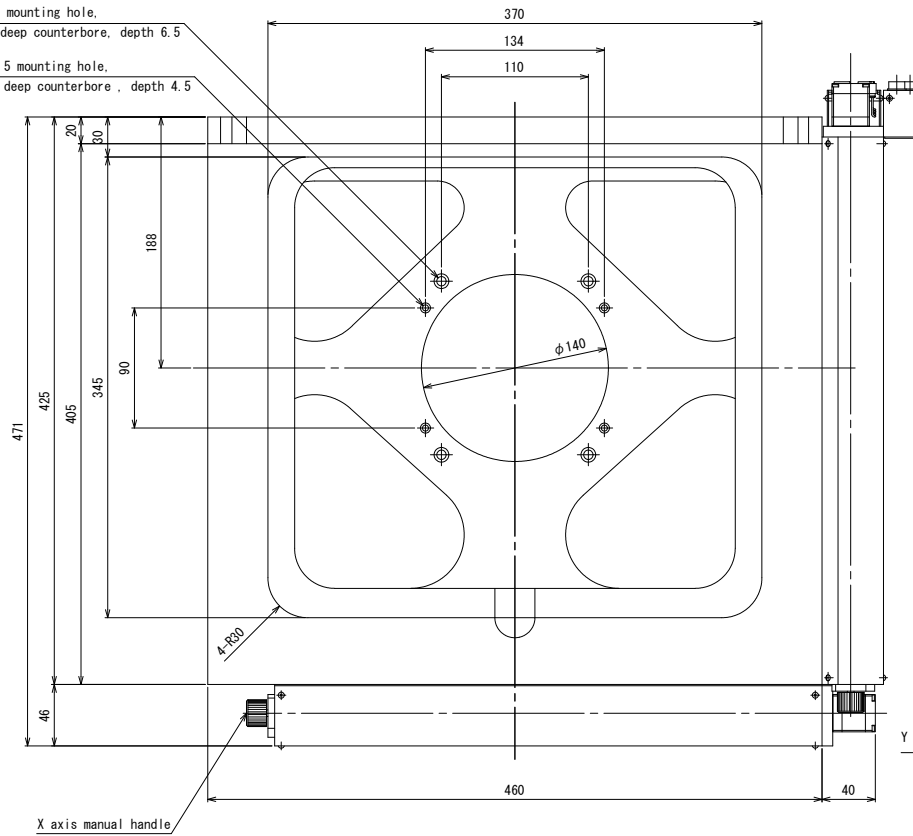
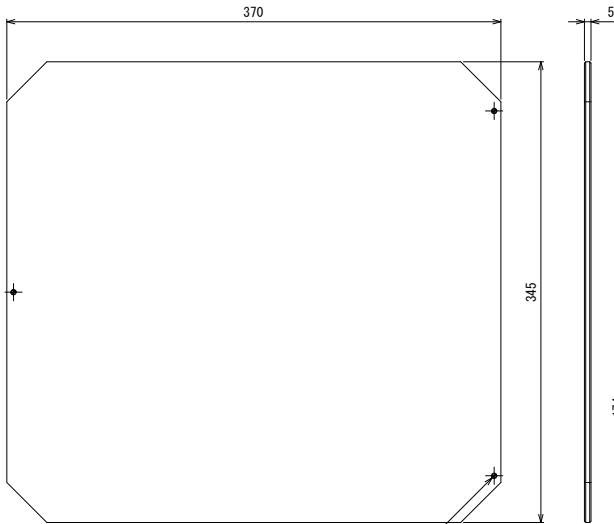
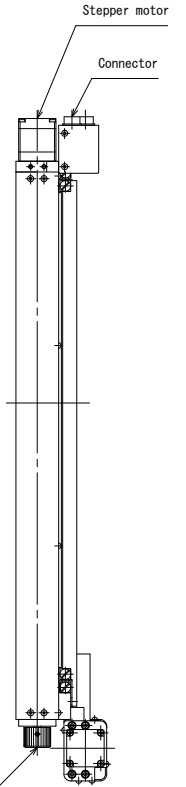

Level adjustment screw (3 points)

Aluminum plate

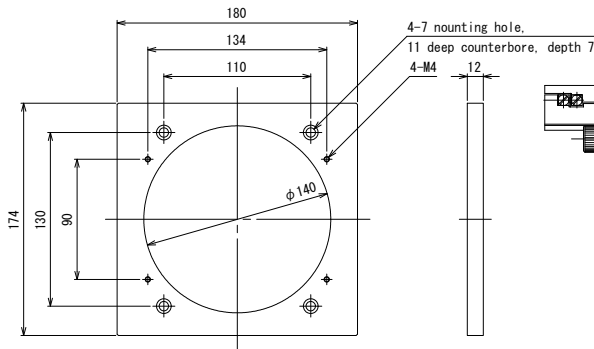

4-7 mounting hole.
11 deep counterbore, depth 7
4-M4

NIKON ECLIPSE L300 spacer included

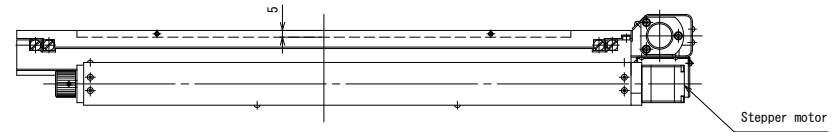

Stepper motor

Microscope
NIKON
ECLIPSE L300
ECLIPSE L300D

MSS-300D-NA
MICRO SCANNING STAGE

CHUO PRECISION INDUSTRIAL CO., LTD.
rev1

*Mounting screw : Hexagon socket head cap screw M4, 4 screws
*Mounting screw : Hexagon socket head cap screw M6, 4 screws